



APPI
technology

Communication
& Safety



HANDS-FREE COMMS

APPI-C^oVR RADIO

APPI-COM[↑]LR RADIO



APPI-Smart Compatible

SAFETYCOMMS FIRST!™

APPI radios offer hands-free conference mode over 3.8 km without fixed or mobile base (Int'l patent).

With the SyncAll® technology, any APPI radio can leave the team (lost signal, etc.) without affecting communication between the others, and then automatically return to the team's COMM : a guarantee for Safety and Efficiency. APPI-Com and APPI-Covr radios are mixable in a group and allow an unlimited number of people in the team.

APPI-COM^{LR}







- | | | | | |
|---|---|--|---|---|
|  |  |  |  |  |
| Bluetooth | ATEX | GSM Compatible | APPI-Smart Compatible | Walkie-Talkie Compatible |
| |  |  |  |  |
| | ICS Compatible | Man down Alert | SCBA Compatible | Water & dust Resistant |

APPI-Com is a long range, wireless and ultralight intercom system : despite obstacles, it ensures a clear communication within the working team in noisy or hostile environments.

APPI-CovR



- | | | | |
|---|--|---|---|
|  |  |  |  |
| Bluetooth | GSM Compatible | APPI-Smart Compatible | Walkie-Talkie Compatible |
|  |  |  |  |
| ICS Compatible | Man down Alert | Water & dust Resistant | PTT/ Duplex |

APPI-CovR is a communicating noise-canceling headset embedding the «APPI» radio technology and its Full-Duplex conference mode. This headset is equipped with a noise cancelling microphone and offers a hearing protection for noisy environments.



BLUETOOTH

Create a gateway to the GSM network with your smartphone to integrate a remote team member.

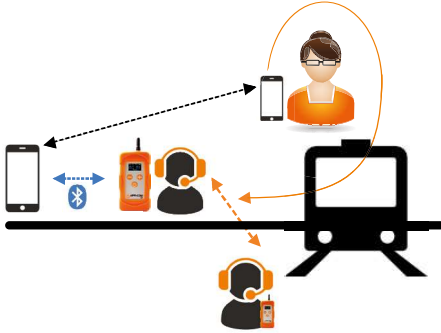

PTT-DUAL

Create a gateway to any Walkie-Talkie network. Communicate on two networks simultaneously.

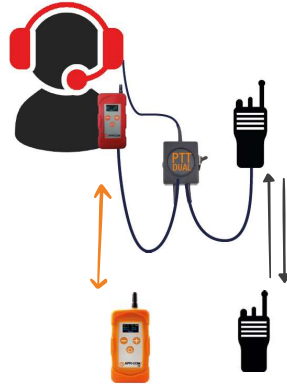

MAN DOWN ALERT

APPI radios are equipped with safety systems; Immobility vocal alert (LWP) or signal loss (Safeline).

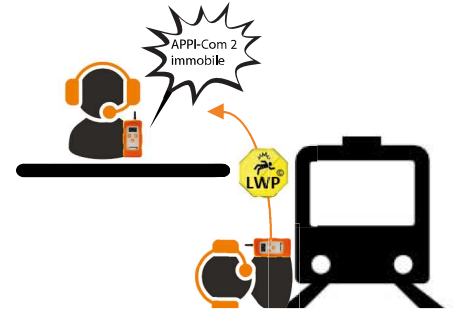

APPI-DEC :

On-board intercom Wireless extension, no installation required.



2.3mi range (3.8km)

OUR SELECTION OF HEADSETS AND ACCESSORIES



IN-EAR BONE CONDUCTION MIC



NOISE-CANCELLING HEADSET WITH TALK TROUGH



BLUETOOTH BONE CONDUCTION HEADSE



REMOTE SPEAKER



SPECIFICATIONS

RADIO APPI-Com LR

Range >2.3mi (4km)

Free bands: 863-870MHz CE / 902-928MHz FHSS

Frequency hopping (scrambled) mode

Up to 50 channels (depends on Country)

Number of users per group : Unlimited

Emission power: less than 500mW

Certifications: CE / FCC / IC / ATEX

SyncAll: no fixed nor mobile base

FEATURES

DSP Based Noise canceler

Pager & Man Down vocal alert

Bluetooth connection to Headsets / Phone / PMR ...

POWER AND BATTERY

Talk time: Up to 9h

Listen time: Up to 10h

Charging on any USB plug

External battery extension

GENERAL CHARACTERISTICS

Size: 3.6x1.9x0.6 in / 91x48x15 mm

Weight: 3 Oz / 80 g

Shockproof : IK8

Watertight : IP67

APPI & APPI-Com
are Registered trademarks

APPI-Technology Inc.
+1 865-722-5729

APPI-Technology SAS - FRANCE
+33 9 83 98 68 73

info@appi-technology.com